

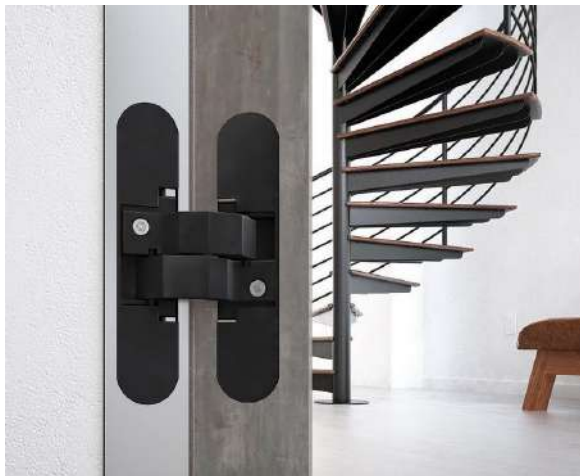

# SUITE 150



**INTERNO**  
DOORS BY ALUMIL



## Description

Suite 150 system consists of a “hidden” aluminum corner frame, for any wall thicknesses and pressed wooden door leaf, available in a variety of surface finishes, such as natural and artificial veneers, special veneers, 3D material, lacquer matte and gloss, as well as just a primed surface to be painted on site with any technique or coated with wallpaper.

The specific door system offers co-planarity with the outside surface of the wall, while still opening inside, or vice versa, apart from normal openings, being ideal for incorporating with its surroundings. The system is equipped in its standard version with magnetic lock and 3 concealed hinges with 3-way adjustability.

### 1. Details - Frame

Corner Aluminium frame consisting of:

- Primary frame which carries the door-leaf
- Grooved surfaces for plaster or mortar enhanced bonding
- Cushioning rubber gasket
- Availability of any RAL color as well as anodizing.

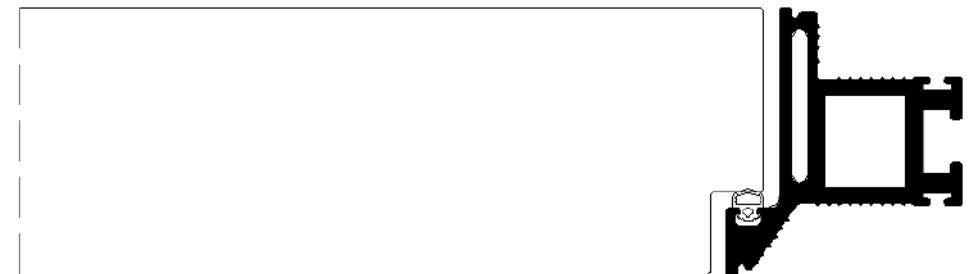
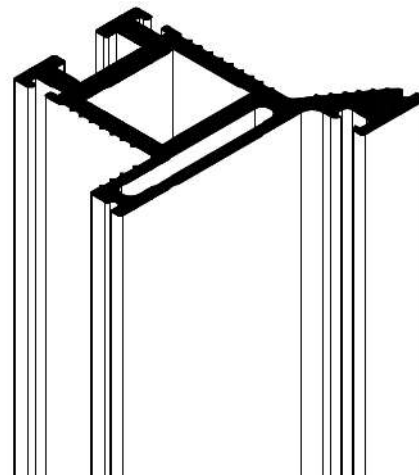
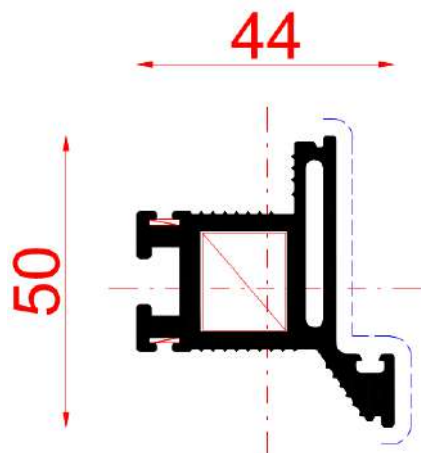

OPENING INSIDE



OPENING OUTSIDE





## Available Dimensions

	WIDTH (mm)	HEIGHT (mm)	WALL THICKNESS
<b>Standard</b>	600 – 900	2150	any
<b>Maximum</b>	1050	3000	any

## 2. Installation

Installation on plasterboard wall and brick wall, opening inside and outside.

### OPENING INSIDE

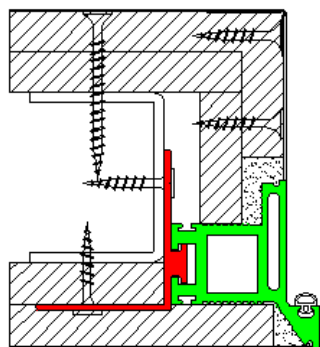

*Plasterboard wall*

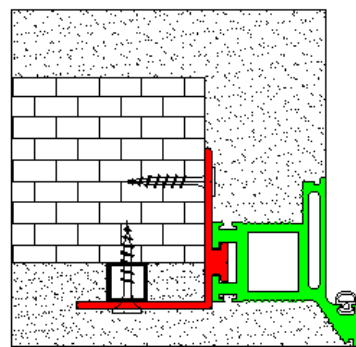

*Brick wall*

### OPENING OUTSIDE

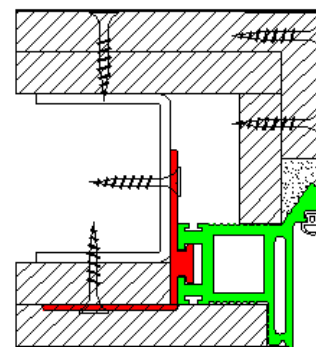

*Plasterboard wall*

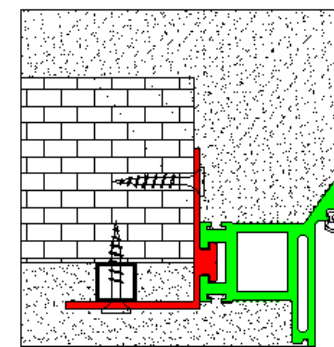

*Brick wall*



## Installation steps

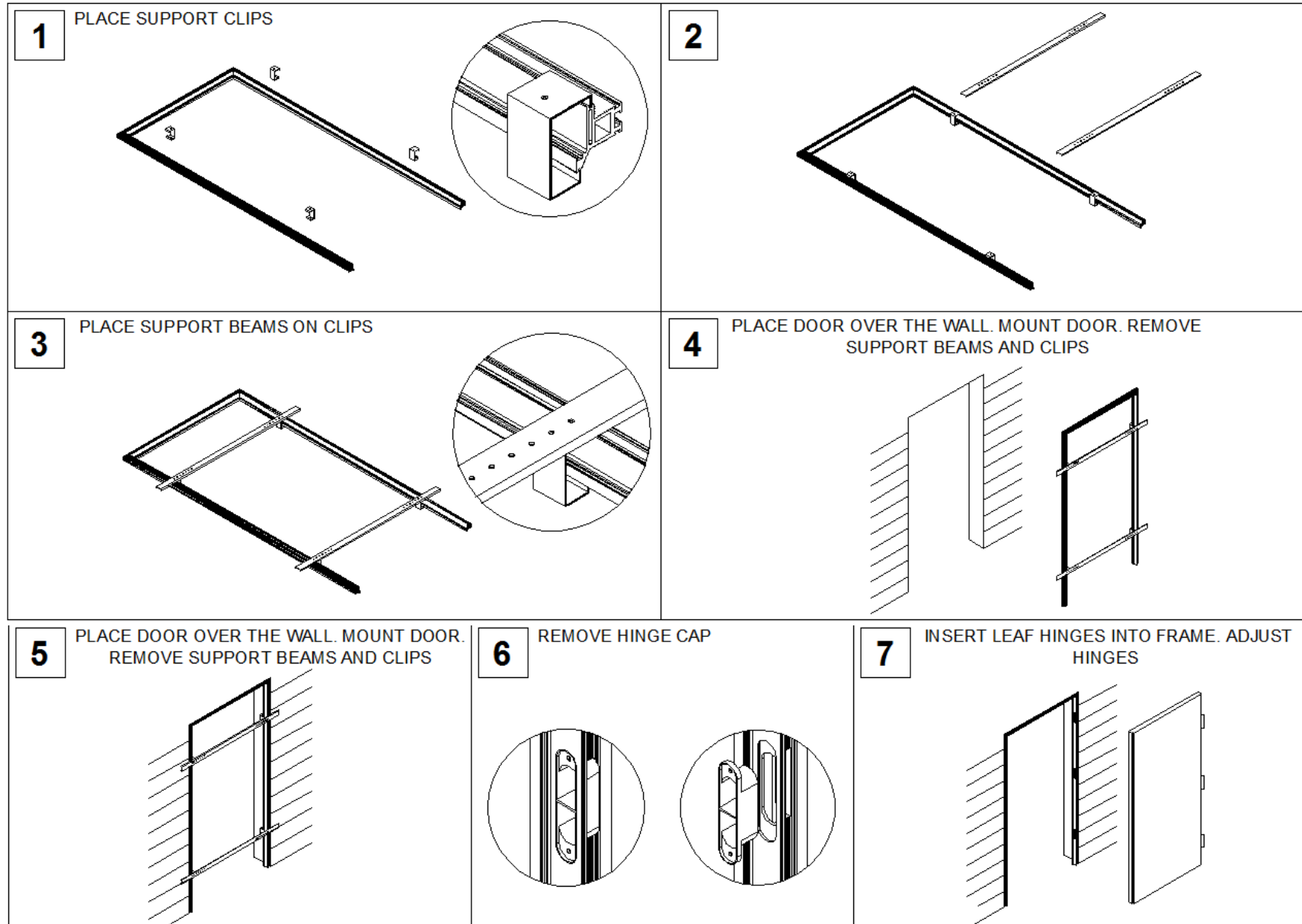

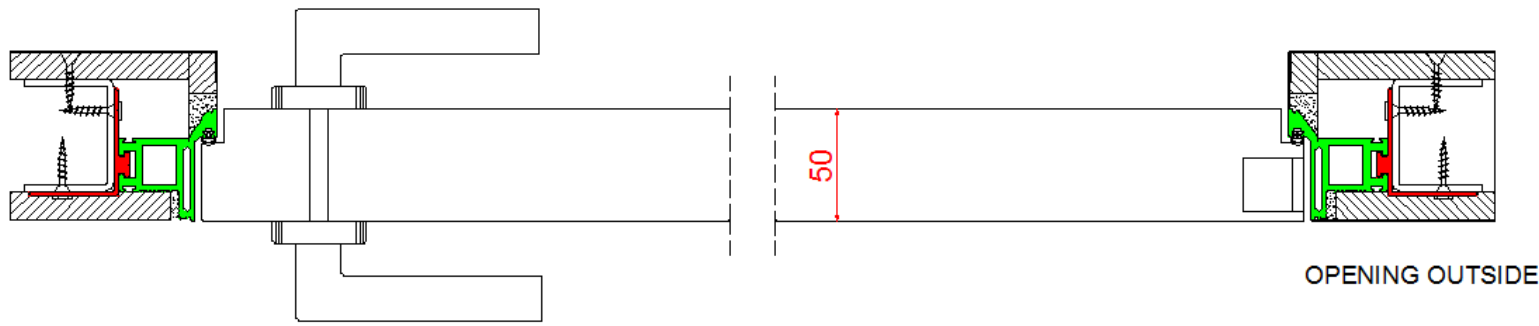
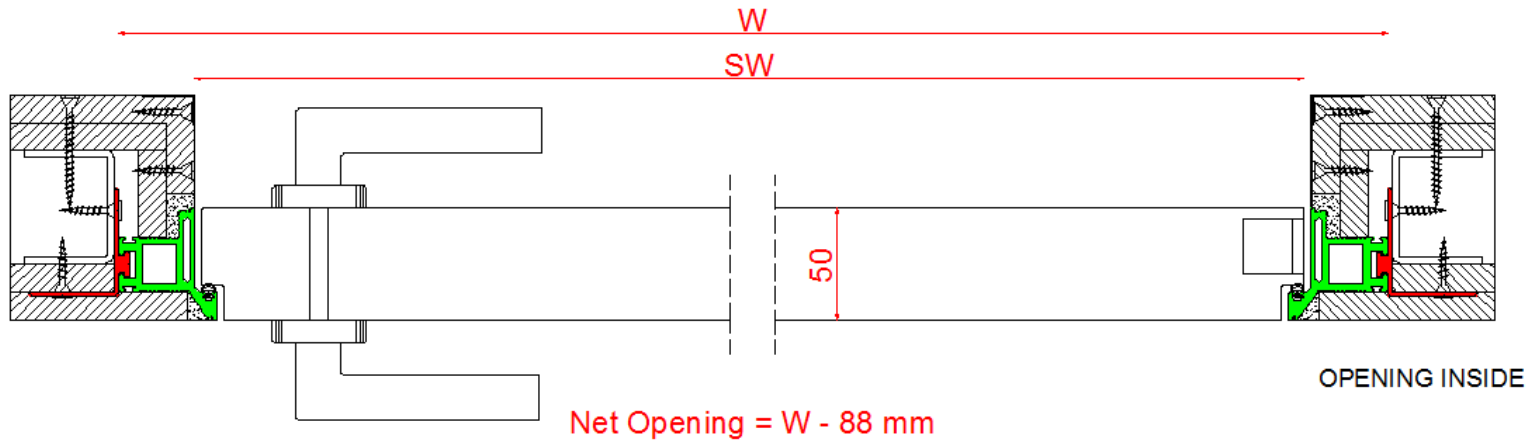

OPENING OUTSIDE

OPENING INSIDE

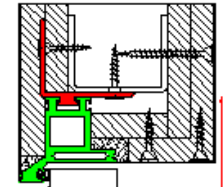
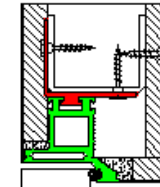

H





### 3. Accessories

MAGNETIC LOCK



CONCEALED HINGE SYSTEM

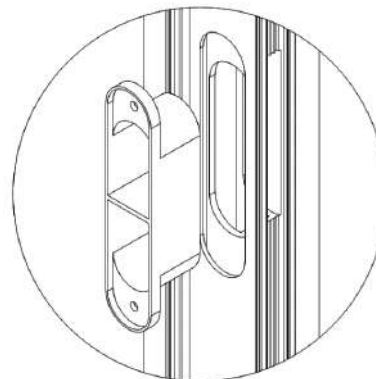

CONCEALED HINGE



### 4. Surface Finishes

FRAME	LEAF
<ul style="list-style-type: none"> <li>▪ RAL MATT</li> </ul>	<ul style="list-style-type: none"> <li>▪ Lacquer Matt</li> </ul>
<ul style="list-style-type: none"> <li>▪ RAL GLOSS</li> </ul>	<ul style="list-style-type: none"> <li>▪ Lacquer Gloss</li> </ul>
<ul style="list-style-type: none"> <li>▪ ANODIZING</li> </ul>	<ul style="list-style-type: none"> <li>▪ Natural Veneer (Oak, Walnut, etc)</li> <li>▪ Special Veneer (Ebony, Walnut, Straight Grain)</li> </ul>
<ul style="list-style-type: none"> <li>▪ SABLE</li> </ul>	<ul style="list-style-type: none"> <li>▪ 3D Material</li> <li>▪ HQL (High Quality Laminates)</li> <li>▪ Primer</li> </ul>