



EXCLUSIVE 300



INTERNO
DOORS BY ALUMIL



Description

Exclusive 300 system consists of divided aluminium frame, which embraces the wall structure and may be installed in any type of construction, offering high technology and numerous coloring combinations between frame and leaf. Exclusive to be a “piece of jewelry”, by offering multiple unique and beautiful surface finishing options. Available in heights up to 3 meters, Exclusive 300 may be installed in any type of wall structure and finished with colored, transparent or mirror structural glazing, carbon fiber, natural and artificial veneers, leather and any lacquer color in matt or gloss effect. The system is equipped in its standard version with magnetic lock and modish stainless 3 concealed hinges with 3-way adjustability.

Consisting of five different cover profiles, Exclusive 300 system could be installed in a wide variety of wall thickness, from 100 to 250 mm.





Installation

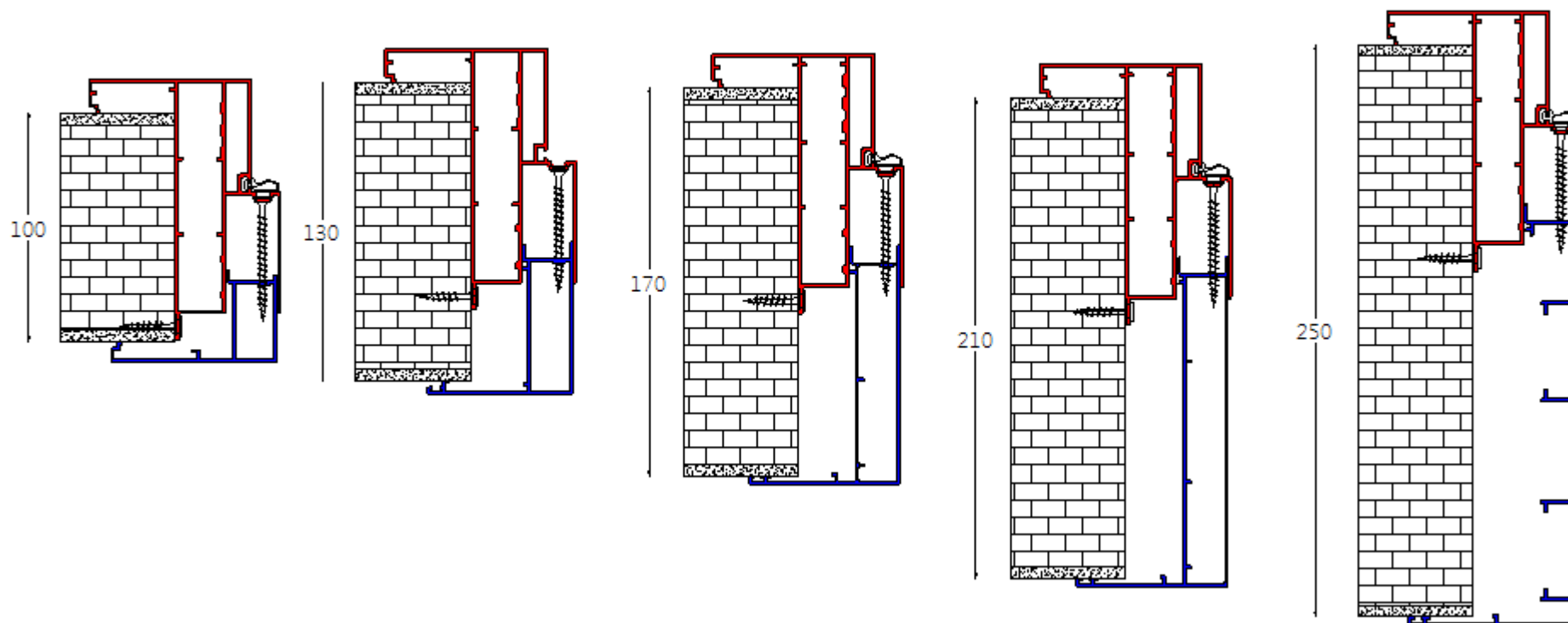

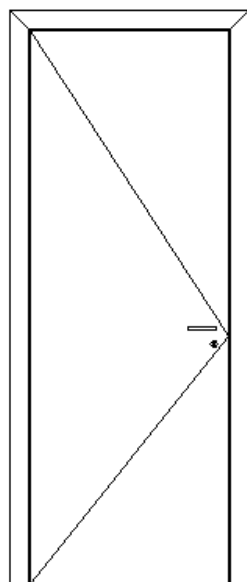
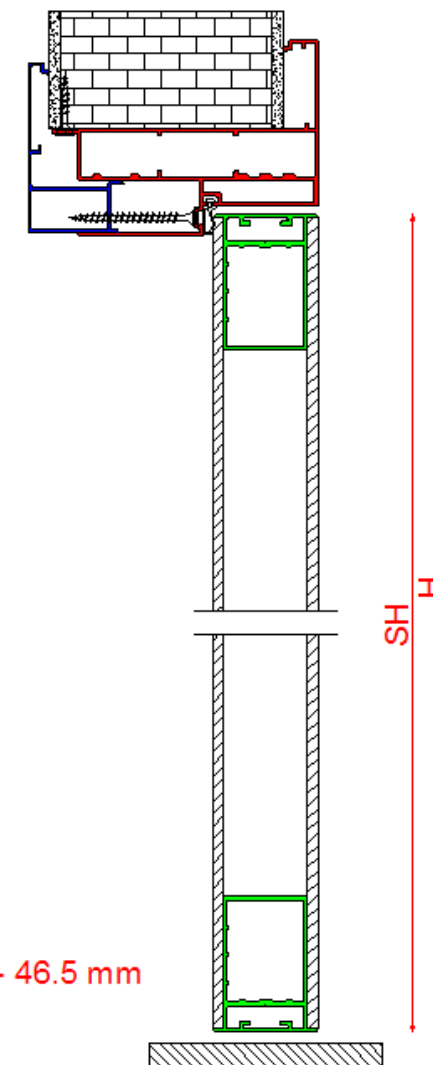
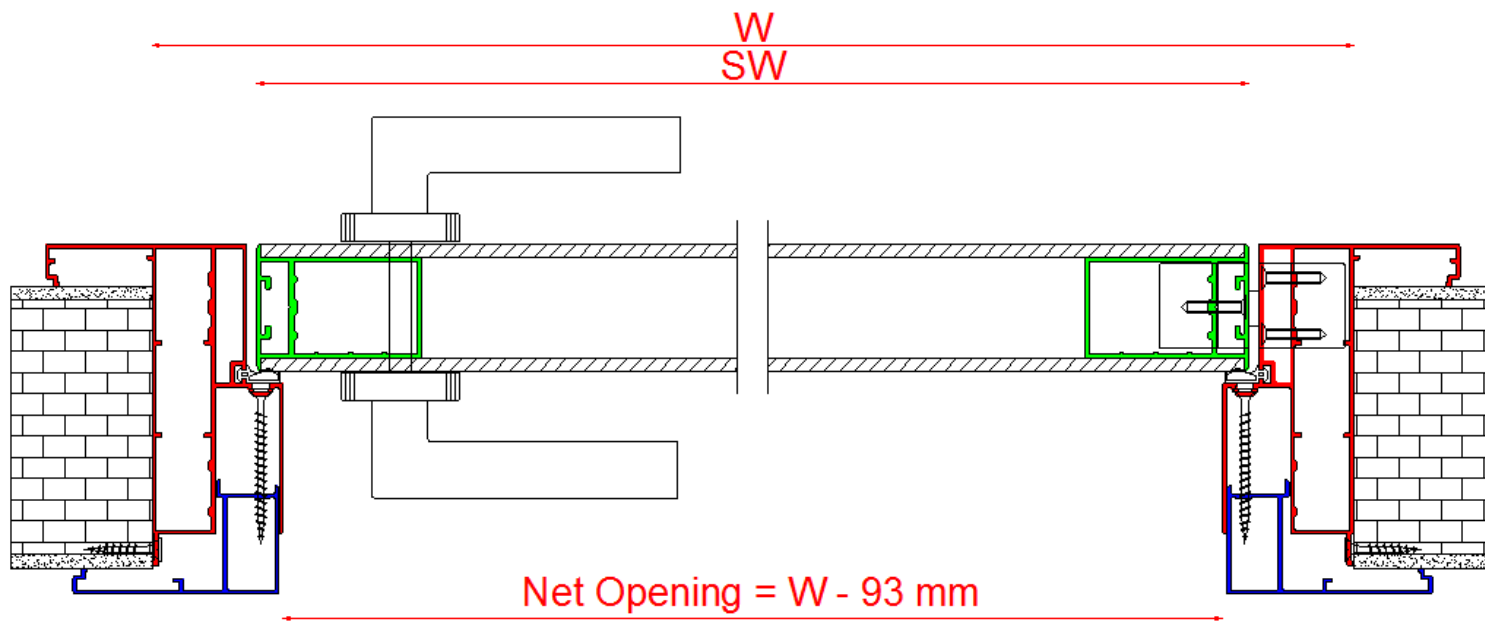



2. Available dimensions

	WIDTH (mm)	HEIGHT (mm)	WALL THICKNESS (mm)
Standard	900	2150	-
Maximum	1000	3000	from 100 to 250

3. Accessories

MAGNETIC LOCK



CONCEALED HINGE SYSTEM





4. Surface finishes

FRAME	LEAF
▪ RAL MATT	▪ Lacquer Matt / Lacquer Gloss / Lacquer Textured ▪ Carbon Fiber Matt / Gloss ▪ Lacquer Gloss ▪ Anodizing Colors / Anodizing Effects
▪ RAL GLOSS	▪ Natural Veneer (Oak, Walnut, etc) ▪ Special Veneer (Ebony, Walnut, Straight Grain)
▪ ANODIZING	▪ 3D Material ▪ Artificial Leather
▪ SABLE	▪ Glass (transparent, colored, laminated, special)